

National Distribution Tel: 213-380-5560
 Toll Free: 888-380-5575 Fax: 213-380-5561

TILE TECH'S SPACER-PLATE™ ARE DESIGNED TO BE USED WITH OUR HEX-TRAYS & PORCELAIN PAVERS TO QUICKLY AND EFFECTIVELY INSTALL OVER JOISTS RESULTING IN MAXIMUM STABILITY, PRECISE AND LEVEL SPACING OF TRAY & PAVER SYSTEM. THE SPACER-PLATES IS AN EXTREMELY SIMPLE BUT VERSATILE COMPONENT WITH A LARGE 5.5" DIAMETER SURFACE AREA FOR ADDED STABILITY OVER JOIST. BUILT-IN 1/18" OR 1/16" PERFORATED SPACERS FOR UNIFORM JOINT SPACING BETWEEN TRAY & PAVER SYSTEM, IN ADDITION TO 1/18" OR 1/16" SHIMMING FEATURES FOR VERTICAL LEVELING OF TRAY & PAVER SYSTEM (NO NEED FOR REPLACING JOIST!). THE DISK CAN BE CUT INTO EITHER A HALF OR A QUARTER-UNIT (USING AN UTILITY KNIFE) TO BE USED ALONG THE EDGE OF WALLS.

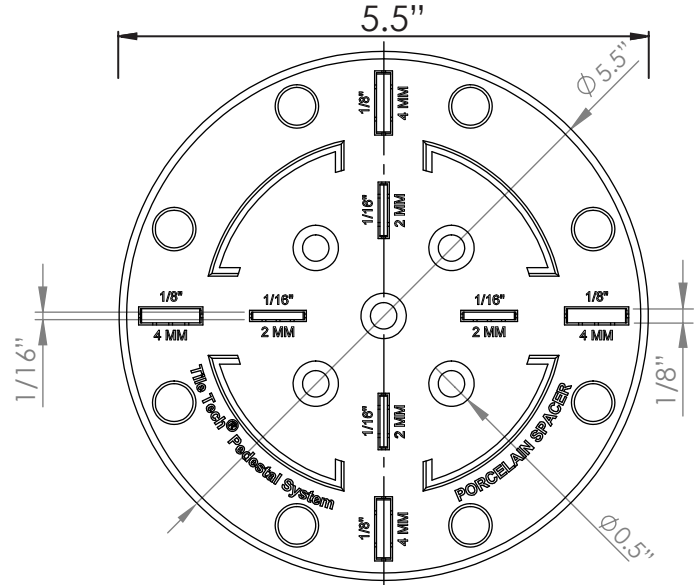

TOP SIDE

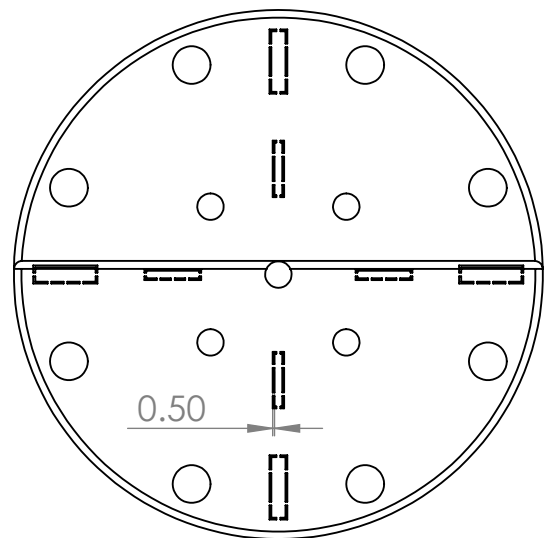
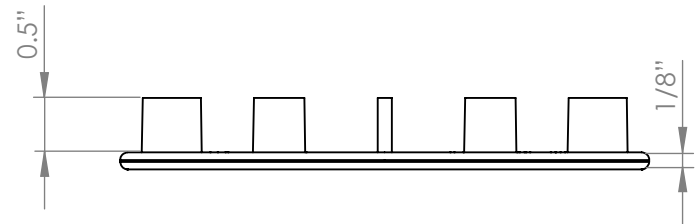
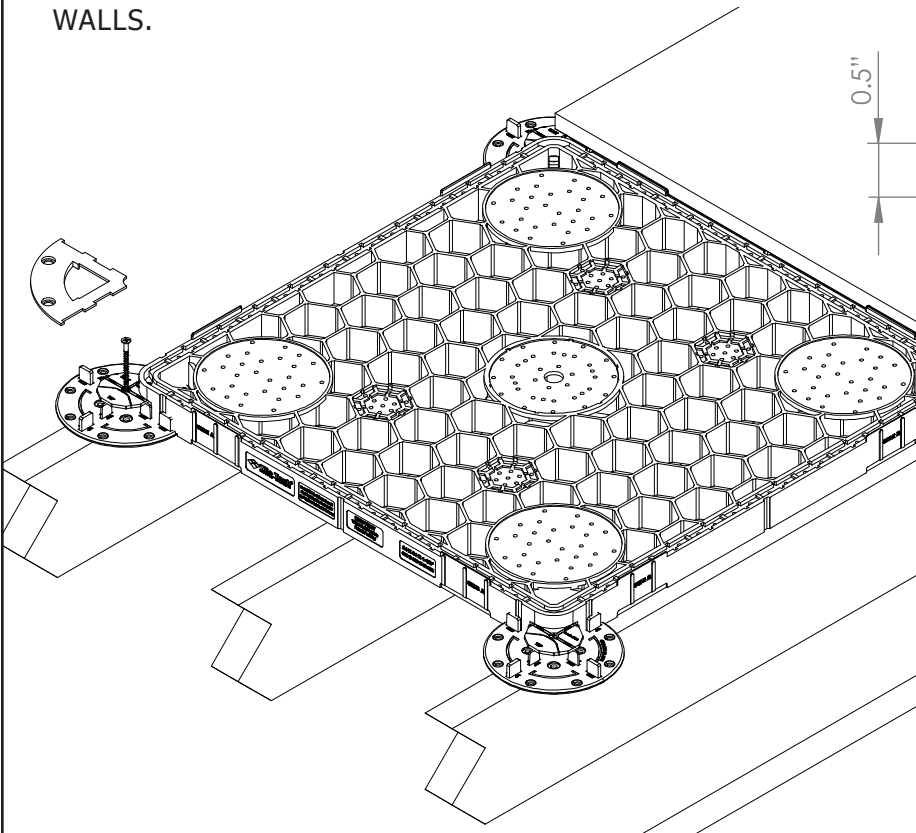

BOTTOM SIDE

GENERAL NOTES: APPLY TO ALL OF THE ABOVE PRODUCTS

1. INSTALLATION MUST BE COMPLETED IN ACCORDANCE WITH TILE TECH PAVERS PRODUCT SPECIFICATIONS.
2. DRAWING NOT TO SCALE.
3. CONTRACTOR'S NOTE: FOR PRODUCT AND COMPANY INFORMATION VISIT www.TILETECHPAVERS.com